

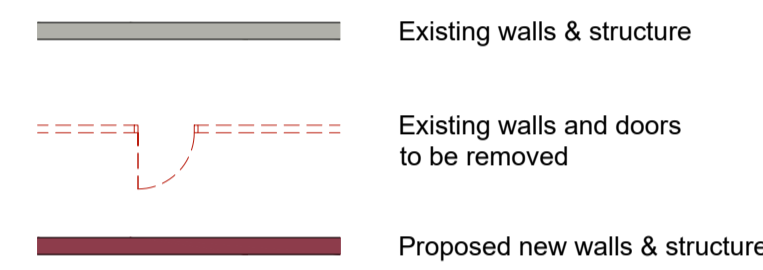

- Notes:
1. This is an AI drawing, if reproduced in any other format the scale shown will be incorrect.
 2. Do not scale off this drawing.
 3. Any ambiguities, omissions and errors, or inconsistencies with other documents, on this drawing should be notified immediately to the architect before the commencement of works on site.
 4. All dimensions are in millimeters unless otherwise stated.
 5. All dimensions, unless otherwise stated, are to the face of unfinished masonry walls or to the face of stud partitions, excluding plasterboard.
 6. All dimensions are to be checked on site. any discrepancies are to be notified immediately to the architect before the commencement of works on site.
 7. All levels are in meters unless otherwise stated.
 8. This drawing is to be read in conjunction with all other relevant drawings and specifications for this project and apparent inconsistencies brought to the attention of the architect.
 9. It is the responsibility of specialist roofing/wall cladding/insulation manufacturer to ensure full compliance with their composite build up as specified by them, and that the integration of their product into the building design meets the required fire tests and complies with Building Regulations.

KEY



NOTE: ALL DEMOLITION WORKS TO BE IN CONJUNCTION WITH STRUCTURAL & M&E ENGINEERS ADVISE

| | | | | | |
|-----|----------|-------------|----|----|----|
| P01 | 03.02.23 | FIRST ISSUE | RR | XX | XX |
| Rev | Date | Description | By | Ck | Ap |



T: 0115 948 1144
 www.cbp-arch.co.uk
 44 The Ropewalk, Nottingham, NG1 5DW

Project
 Bracken Lane Primary Academy
 Retford:
 School Remodeling

Drawing title
 Proposed GA Floor Plan
 (Option C)

| | | | | | | | | |
|----------|------------|-------------|-------|----------|------------|--------|-------------|----------|
| Drawn by | Checked by | Approved by | Scale | Date | RIBA Stage | | | |
| AM | RR | X | 1:100 | Feb 2023 | 3 | | | |
| Project | Originator | Volume | Level | Type | Role | Number | Suitability | Revision |
| 21176 | -CBP- | Z1 | -GF- | DR-A- | 3500-S2 | -P01 | | |

Reproduced subject to copyright Original sheet size A1

Proposed GA Floor Plan
 scale 1:100 @ A1

